

### Product Description

Flintec Force Transducers are designed to meet the most stringent accuracy requirements. The CT2 *Fatigue Rated* shear web metric series force transducers offer:

### Key Features

- Capacities: 1.25 kN to 225 kN
- Fatigue rated to 100 Million reverse cycles
- High accuracy (0.03-0.05%)
- Low height
- First choice for structural and materials testing
- Guaranteed maximum off-centre load and moment error
- Low creep
- Low susceptibility to magnetic fields
- Barometric pressure compensated
- Temperature compensated
- Bayonet connector
- Protection IP 67

### Options

- Additional bridges
- Output adjustment to standard
- Compression overload protection
- Integral cable
- Custom connectors
- Imperial versions available

### Available Accessories

- Mating connector
- Loading fixtures
- Interconnection cable
- Shunt calibration connector
- Instrumentation

## Specifications

MODEL			CT2-10M-	CT2-10M-	CT2-20M-	CT2-30M-
Maximum capacity	(E <sub>max</sub> )	kN	1.5 / 2.5 / 5	12,5 / 25	50 / 125	225
ACCURACY						
Static error band		%•R0	≤ ± 0.03	≤ ± 0.04	≤ ± 0.05	
Non-linearity		%•R0	≤ ± 0.04	≤ ± 0.04	≤ ± 0.05	
Hysteresis		%•R0	≤ ± 0.03	≤ ± 0.04	≤ ± 0.05	
Non-repeatability		%•R0	≤ ± 0.01			
Creep error (20 minutes)		%•R0	≤ ± 0.03			
Off-centre load sensitivity		%•R0/cm	≤ ± 0.4			
Side load sensitivity		%•R0	≤ ± 0.1			
Zero balance		%•R0	≤ ± 1.0			
TEMPERATURE						
Compensated temperature range		°C	-10...+45			
Operating temperature range		°C	-55...+90			
Temperature effect on sensitivity	(TC <sub>LC</sub> )	%•of reading/°C	≤ ± 0.0015			
Temperature effect on zero	(TC <sub>0</sub> )	%•R0/°C	≤ ± 0.0027			
ELECTRICAL						
Rated Output	(R0)	mV/V	1 ± 10%	2 ± 10%		
Excitation voltage		V	recommended 10, max. 20			
Input resistance	(RLC)	Ω	350 +40/-3.5			
Output resistance	(Rout)	Ω	350 ± 3.5			
Insulation resistance (50 V DC)		MΩ	≥ 5000			
MECHANICAL						
Safe load limit	(E <sub>lim</sub> )	%•E <sub>max</sub>	300			
Weight		kg	1.2	3	10	24
Flexure material			aluminium	steel		
Protection according DIN 40.050			IP 67			

## Dimensions (in mm)

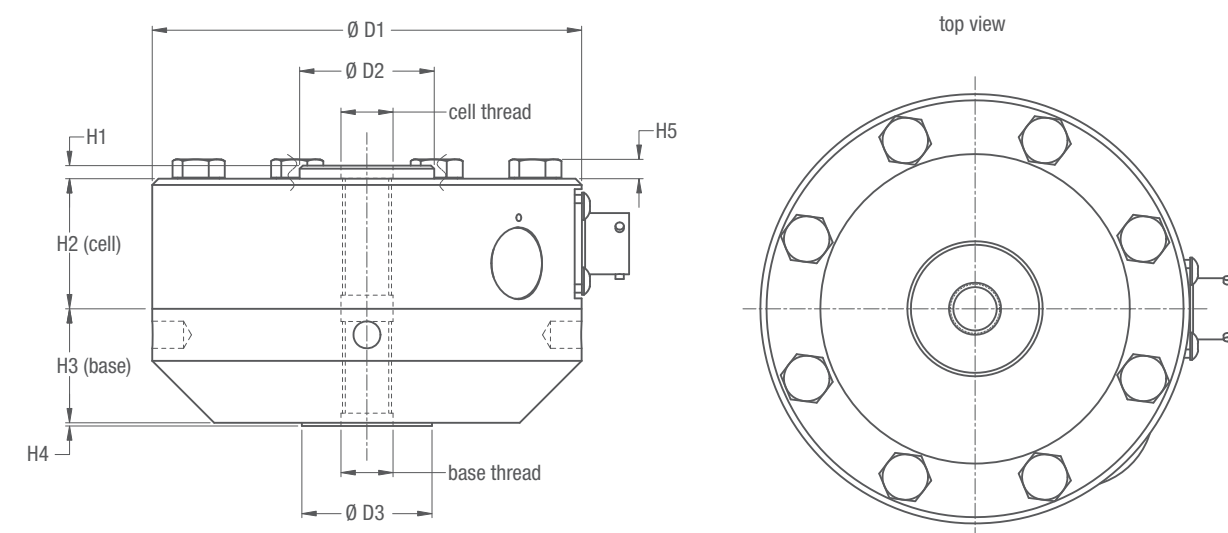

Type	H1	H2	H3	H4	H5	D1	D2	D3	cell thread	base thread
CT2-10M-1.25/2.5/5 kN	3.1	31.8	28.7	0.8	5.1	104.8	32.8	31.8	M12x1.25	M12x1.25
CT2-10M-12.5/25 kN	3.1	31.8	28.7	0.8	5.1	104.8	32.8	31.8	M16x2	M16x2
CT2-20M-50/125 kN	3.1	41.4	44.5	0.8	7.6	154.0	100 kN-59.4 250 kN-65.5	57.2	M33x2	M33x2
CT2-30M-225 kN	6.3	57.2	50.8	0.8	10.2	203.2	95.5	76.2	M42x2	M42x2

## Wiring

- The force transducer is provided with a bayonet connector.